

"Pet Beds"

with Chris Nolen

Jun 20th, 2013

Humane Society would like our help in making pet hammocks. Chris Nolen will demonstrate how to make the hammock, and will also show how to assemble the pet bed frame from PVC parts, in case you want to make one for your own pet(s).

The hammock requires either home decorating weight fabric or two layers of quilting cotton.

It may be pieced or be cut from a single large piece of fabric.

It is fastened with Velcro, so if you have any Velcro to donate, please bring to Chris.



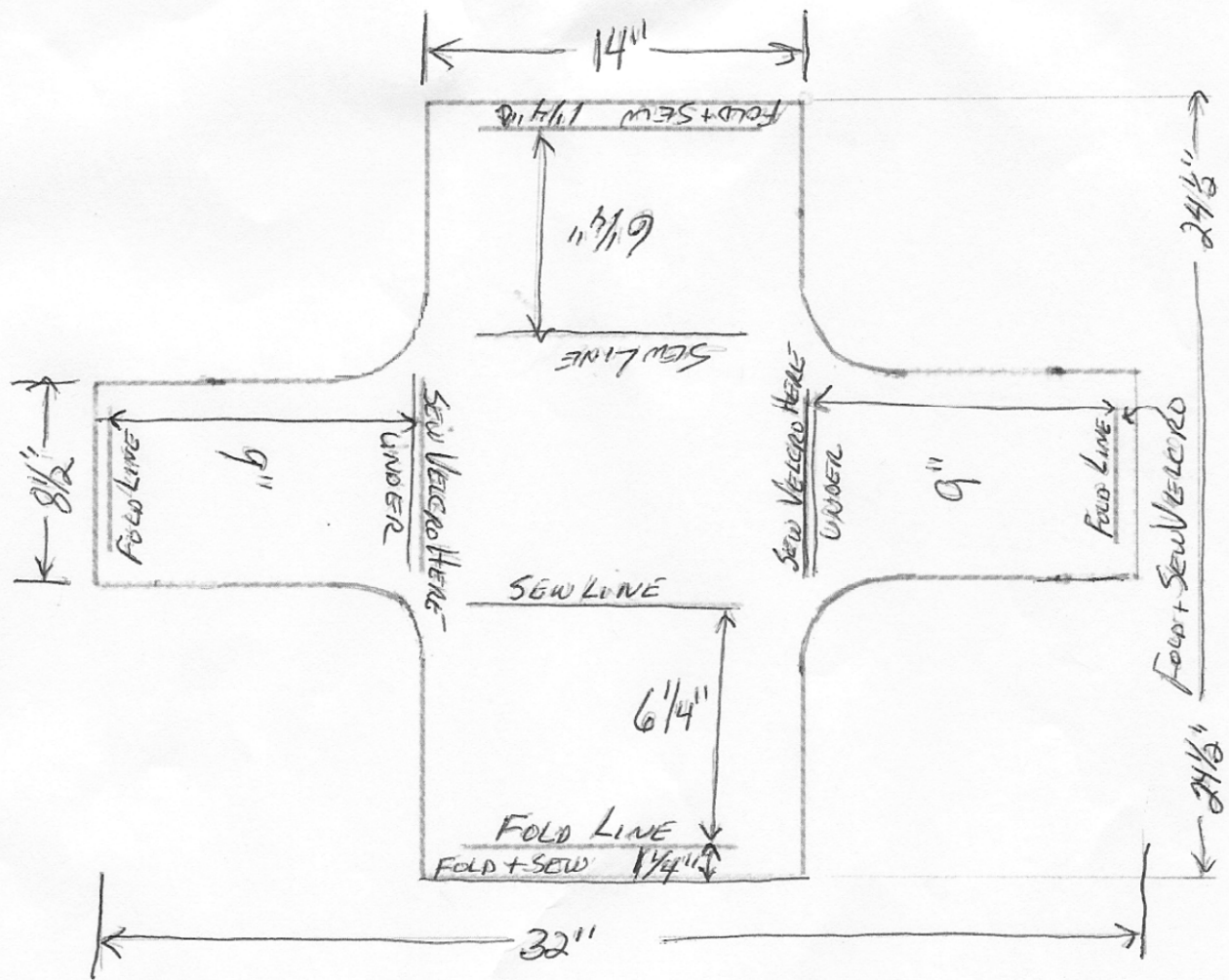

This is not to scale but will give you the dimensions of the template. On the 14 in. flap you will fold 1 1/4 in. to the underside and sew in place and then sew that edge 6 1/2 in. on the underside. This will create a tube. Do the same on the opposite side. On the 8 1/2 in. flap measure 9 in. from the edge and sew a Velcro strip on the underside. From the edge fold 7/8 in. to the underside and sew a Velcro strip on it.